

不锈钢轴承系列产品

Stainless bearing range introduction

不锈钢外球面轴承及轴承座 / Stainless steel spherical bearings & Stainless steel housing

- 轴承的外径与轴承座内径为球面配合，两者之间具有自动调心功能，可补偿因安装误差产生的轴线不重合及安装底面的变形。带座外球面球轴承不仅能承受径向负荷，而且能承受较大的轴向负荷。同时轴承工作噪音小。不锈钢轴承座为整体座结构，轴承座刚性极好，防止轴承在装配时产生变形，在任何工况下轴承座均持久耐用。轴承及轴承座都经过精密加工，轴承与轴承座可完全互换，随时都可方便地更换轴承。轴承座采用SUS304材料，外球面轴承使用SUS440C材料。特殊用途也可以使用SUS316材料。
- The outside diameter of the self-contained bearing is ground spherical to match corresponding spherical inside diameter of the housing providing self-alignment between these two members, which compensates for misalignments of the units resulting from errors in mounting and distortion of the foundation. Insert Ball Bearing Units can sustain radial loads and substantial thrust loads as well. Quiet operation is also assured. The Stainless steel housing is of solid one-piece construction to provide maximum rigidity against deformation at mounting and wear resistance for any operating condition. Skilled precision workmanship on the self-contained bearing and the housing provides for complete interchangeability between them and the bearing can be easily replaced whenever so required. Anti-corrosion etc. Bearing housing is made of SUS304 and the insert bearings are made of SUS440C, Specially SUS316 also could be used.

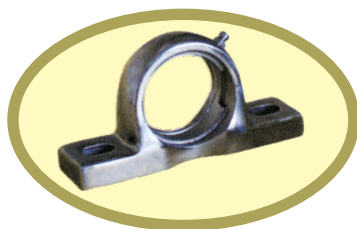

立式座 Pillow block type

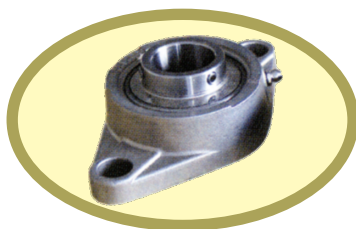

菱形座 Rhombic-Flanged type

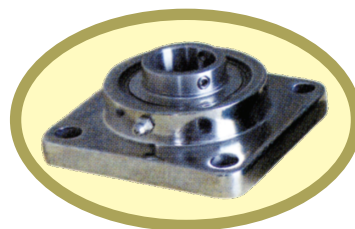

方形座 Square-flanged type

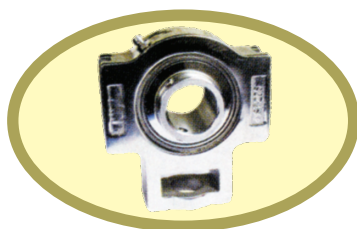

滑块座 Square-flanged type



不锈钢外球面轴承及轴承座系列
Stainless steel spherical bearings
Stainless steel housing